

A3

DO NOT SCALE

File: CP1770-BLP-04-ZZ-M2-MA-0403-00 Cross Section I-I at Channel Widening.dwg
Date: Jul 04, 2019 - 4:24pm Plotted by: TJOCConnell

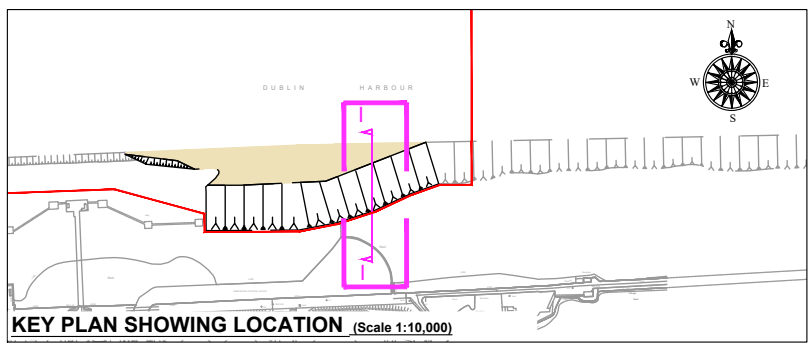
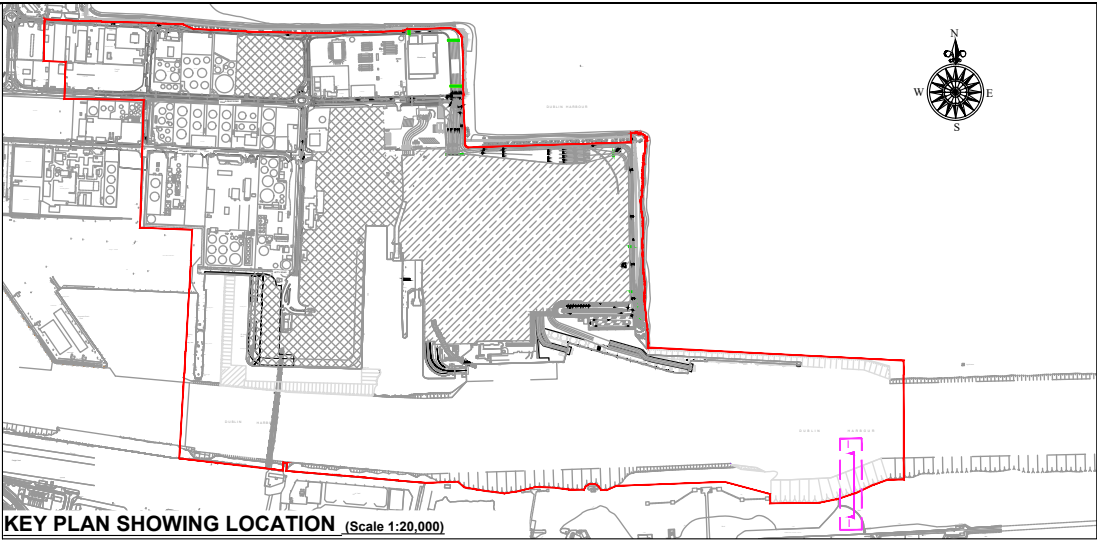

- GENERAL NOTES**
- ALL DIMENSIONS ARE IN MILLIMETRES UNLESS NOTED OTHERWISE.
 - ONLY WRITTEN DIMENSIONS SHALL BE USED. NO DIMENSIONS SHALL BE SCALED FROM THE DRAWINGS.
 - ALL LEVELS ARE IN METRES AND ARE TO ORDNANCE DATUM MALIN UNLESS NOTED OTHERWISE.
 - ALL COORDINATES ARE IN METRES AND ARE TO IRISH TRANSVERSE MERCATOR.
 - DRAWINGS ARE TO BE READ IN CONJUNCTION WITH THE SPECIFICATION.
 - ALL DRAWINGS ARE THE PROPERTY OF ATKINS BYRNELOOBY.
 - [xx.xx m CD] REFER TO LEVELS AT CHART DATUM (DUBLIN PORT).
 - ORDNANCE DATUM MALIN [O.D.M.]
- CHART DATUM [C.D.] (DUBLIN PORT) +2.5m = ORDNANCE DATUM MALIN [O.D.M.]
- KEY PLAN LOCATION.
 - OS MAP SHEET NO:
3198-18, 3198-19, 3198-20, 3198-23, 3198-24, 3198-25, 3199-16, 3199-17, 3199-18, 3199-21, 3199-23, 3199-24, 3264-2, 3264-3, 3264-4, 3264-5, 3264-8, 3264-9, 3264-10, 3264-13, 3264-14, 3264-15, 3265-1, 3265-6, 3265-7, 3265-8, 3265-9, 3265-11, 3265-12.

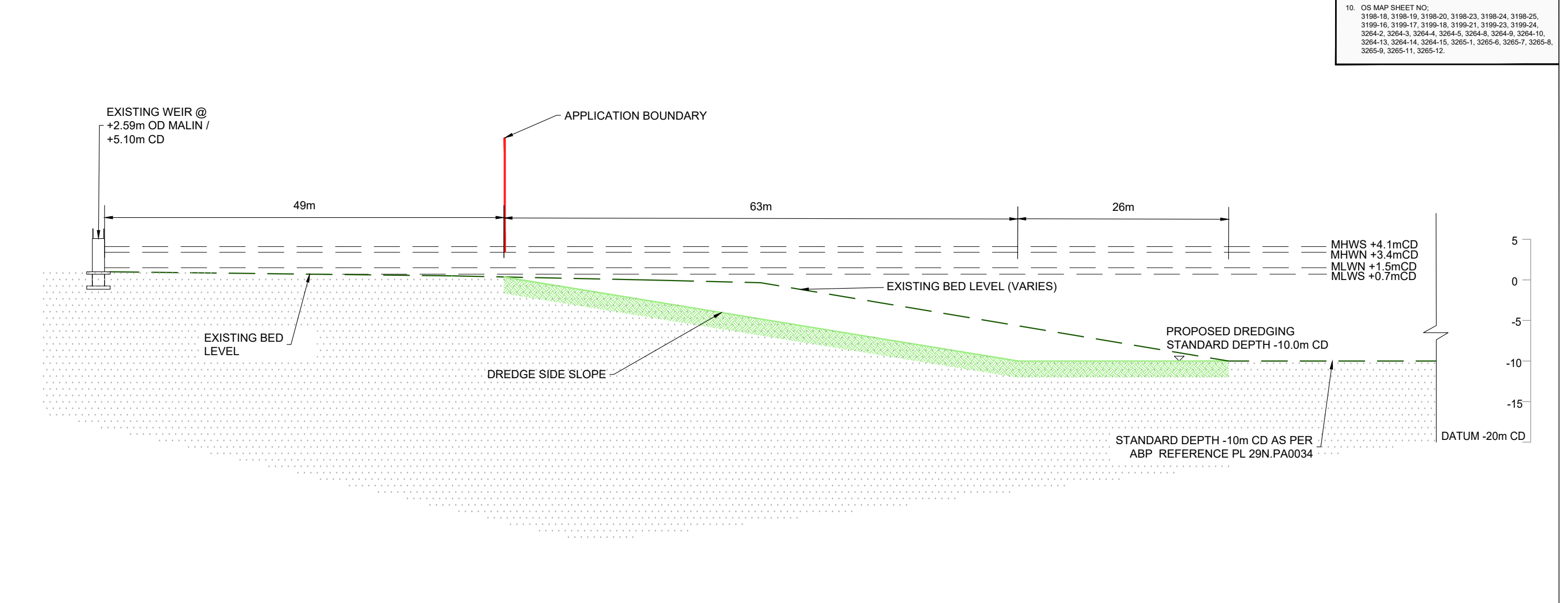

CROSS SECTION I-I (Scale 1:500)

Ordnance Survey Ireland Licence No. EN 0061919
© Ordnance Survey Ireland/Government of Ireland

	APPLICATION BOUNDARY		PROPOSED BED LEVEL
	PROPOSED SCOUR PROTECTION MATTRESS ON SEA BED		
	DREDGED SIDE SLOPES		
	PROPOSED DREDGED AREA		
	EXISTING BED LEVEL		

Rev	Description	By	Date	Chk'd	Auth
00	ISSUED FOR PLANNING	TJOC	07.19	SMC	AC

ATKINS
Member of the SNC-Lavalin Group
BYRNELOOBY
WS Atkins Ireland Ltd. & ByrneLooby Partners Ltd.
Atkins House,
150 Airside Business Park,
Swords, Co. Dublin

Client
COMHLACHT CHALAFORT
ÁTHA CLIATH
DUBLIN PORT COMPANY

Project
MP2

PLANNING			
Title CROSS SECTION I-I AT CHANNEL WIDENING (SOUTH OF EXISTING NAVIGATION CHANNEL)			
Original Scale 1:500 @A3	Design/Drawn TJOC Date 28.09.18	Checked SMC Date 28.09.18	Authorised AC Date 28.09.18
Status P	Drawing Number CP1770-BLP-04-ZZ-M2-MA-0403	Rev 00	